

PITCHFORK

Pappinbarra Valley Monthly News

Pappinbarra Progress Association

PPA President's Report—We hope Jean and George are having a great time in Ireland

Commercial Kitchen for the Hollisdale Hall?

The Hollisdale Hall, the central meeting point for the Pappinbarra community, has been used for all kinds of different events over the years. In the past people used the kitchen as an extension of their own kitchen to prepare food for community events in the Hall. Sadly this can no longer be the case. All levels of government - local, state and federal - increasingly impose their laws and regulations on the use of community halls, especially when it comes to the preparation of food.

The PPA, on behalf of the community, is very keen to broaden the usage of the Hall. It could be rented out for wedding receptions etc and be used by the Association and other members of the community to put on plays, music events and other celebrations where preparation of food may be a requirement. It could also be used by members of the community who want to value add to their produce,

e.g. make cheeses, jams, pickles etc and sell these at farmers' markets and other retail outlets.

For quite some time now there has been a debate amongst committee members and others about having a commercial kitchen as part of the Hall. The discussion centred round upgrading the existing kitchen but, on the whole, this idea has been discarded because the kitchen is the old original school building and it is felt that it should be kept in its original state. Getting it up to commercial kitchen standard would greatly alter its character. Now the discussion is focused on the possibility of adding a new kitchen that could eventually be brought up to commercial standard to the south side of the hall. The existing kitchen could be converted to a meeting space and a library with comfortable seating for reading. The PPA has begun to look into what this would involve and cost and will keep the community informed about this proposed big change through a regular feature in Pitchfork. If you have any comments or suggestions contact Jean Hegarty jeanmay@bluemaxx.com.au

PPA Committee

November Special Events

Bec and Dave Mann

A powerful alchemy took place when Bec and Dave met in the Northern Territory a few years back. Simply said, these two were meant to sing together. Now as a family they travel the country in their eco friendly home on wheels, singing up stories that inspire a campfire in the heart. We're lucky to have them play for us at our local Hall, supported by the Scarlet Runners with our own Ryan Barter. Join us for an evening of great music!

Pappinbarra Progress Association

Presents

...a Saturday evening with

Bec & Dave Mann

Supported by our home grown "Scarlet Runners"

Join Bec and Dave for an informal semi acoustic concert in the beautiful Pappinbarra Valley, supported by local artists.

Hollisdale Hall

Saturday 24th November

From 6.00pm

All tickets sold at the door

\$15 Adults \$10.00 Conc.

BYO Drinks
Sausage sizzle

Music with an easy honesty that is infectious and intimate.

This folk-blues ensemble features slide guitar, mandolin and bouzouki mixed with vocal harmonies that meld like a soothing velvet drink



Forthcoming Events – December

Christmas Party, Upper Pappinbarra Facilities

With Santa promising to arrive in true country style again this year, this will be the usual great community get together especially for the kids at the Upper Pappinbarra facilities. Pencil **22 December** in your diaries, date to be confirmed. See the December Issue for details.

And coming up **New Year's Eve** and **Australia Day** celebrations – see **December Issue** for details.

Photo Competition – Deadline extended to November 10

We're looking for 12 great photos that capture the essence of Pappinbarra Valley as seen through local eyes for a 2013 calendar. Landscapes, the dog on the back of the ute, kids in the back yard, your produce in full glory an image that it will be evocative and pleasing for your fellow Pappinbarrians to look at for a month. Send your high resolution A4 size image(s) to Jean Hegarty by November 10. jeanmay@bluemaxx.com.au

Congratulations to Heather McKenzie!

Our wonderful young bagpiper, known to many of us from her performances at the Hall on various occasions, has won an \$8,000 award from Pipe Bands NSW and the Big Brother Movement to travel to Scotland in June next year to be taught by some of the world's best players and play at the World Pipe Band Championships. What a fantastic achievement! In honour of this win, let's meet this neighbour

Meet the Neighbours—Heather McKenzie

17 year old Heather McKenzie lives on a farm in the Valley with her Mum Kerrie, Dad Mal and brother Connor. Born at Port Macquarie Base Hospital, she's a local girl through and through. Home schooled by her Mum, she says that this was "the best thing that ever happened to me - I wouldn't have wanted to go to school. Mum did a great job." There were no set lessons or content, her Mum coming up with the work she wanted them to do. She and her brother occasionally got together with other home school kids for outings and to do school work.

For his 14th birthday, Connor was given bagpipe lessons. Heather hated the sound (*did he have to play out in the back paddock?*) but then Connor taught her a few tunes and she was hooked. Taking lessons from Connor's teacher, Heather was soon competing in city competitions and playing in the local pipe band. In 2011 she won a scholarship to attend a 3-day workshop in Canberra, being taught by international musicians with 100 other young people from around the country. Soon she took on the role of pipe major for the local pipe band, leading 8 pipers and 2 drummers of all ages. In January this year she added another scholarship to her credit, this time travelling



to Melbourne for a week-long workshop similar to the one she attended in Canberra. And now the award to travel to Scotland! For now Heather's goal for piping is to take the local band into competition.

Heather's studying veterinary nursing at Tamworth TAFE by distance education and volunteering 2 days a week at the veterinary clinic in Wauchope. She'd always "sort of had in mind" to do veterinary work, then met the local vet at neighbour Dale Goldfinch's place one day and that cemented it for her. She wants to go on to do veterinary science once she finishes her vet nursing course. She's also studying horticulture. Her favourite activity on the farm is working with cattle – they only have one bull and one steer at the moment but she would like one day to get into Angus and Hereford breeding. And she loves her two dogs – General, a border collie and Bear a kelpie pup. In case her future life isn't quite busy enough, she wants to one day get into breeding kelpies as well. Heather's clearly a young woman who is going places and we wish her all the very best in her various endeavours.

Bev Sibthorpe

Home Brew and Finger Food Competition

What a really nice night was had by all who got together to appreciate the skills of our local brewers and liqueur makers. With entries in all four beer categories the winners were:

Lager - Lyn Blythe (1st), Alan Kilpartrick (2nd), Ron Murphy (3rd);

Stout – Patrick McEntee (1st), Greg Bell (2nd), Ron Murphy (3rd);

Draught - Lyn Blythe (1st), Ron Murphy (2nd & 3rd);

Old – Ron Murphy (1st & 2nd).



Lager and Draught judges—Greg Kilpartrick, Steve Ostler and Alan Kilpartrick

Ron Murphy was overall champion. Julie-Anne took out first prize for her delicious (!) butterscotch **liqueur**, followed closely by Patrick McEntee with strawberry (2nd) and Julie-Anne with choc-mint (3rd). Bev Kilpartrick's chocolate brandy balls were an unchallenged knockout in the **finger food**. There was no ginger beer this year—2013 hopefully? A very big thank you to the team that organised this event, ably led Julie-Anne - judges Lyn Blythe, Steve Ostler, Greg Kilpartrick, Emma Frost, Alan Kilpartrick, Dale Goldfinch and Bev Kilpartrick, chefs Mary Walker (back home between rounds of chemo for a couple of weeks and cooking up a storm), Jan Childs and Elly Franchimont, record keeper Bev Sibthorpe and 'runner' Sue Frost.

Can you give a few hours to the PPA?

There's a huge amount of work involved in making sure the PPA is really active and our precious facilities are maintained and steadily improved. Your hard working committee would love some help. If you can spare a few hours, monthly or just from time to time, we'd love to hear from you. Things we'd really appreciate some help with are:

1. First Friday chef roster – **could you be part of a 3-person team 2 or 3 times a year?**
2. Pitchfork delivery roster – **could you be part of a 2-person team for 4 hours on the last Friday of the month 2 or 3 times a year?**
3. Organising special events. Now including POA's traditional events (see p7), PPAs annual events calendar includes New

Year's Eve, Australia Day, Seniors Week, Easter Bonnet Parade, Trivia Night, Christmas in July, Bush Dance, Cricket Match, Home Brew Competition, Christmas Party, one-off musical and theatrical events and the tennis competition – **could you volunteer a few hours to join the teams putting on these events once or twice a year?**

If you can help – regularly or just being willing to have your name on a list of people we can call up to see if you've got a bit of free time when events are coming up or roster gaps and absences happen - please email Jean Hegarty jeanmay@bluemaxx.com.au.

PPA Committee

RFS Hollisdale and Pappinbarra - Can you make a Donation?

The current fire season has officials concerned about the higher than usual fuel loads in Pappinbarra and surrounding valleys. This is a result of the long time between hazard reduction burns due to the wet conditions we had. Already both Hollisdale and Pappinbarra brigades have been quite active in both our own and neighbouring valleys and summer is still to come. We've recently had to do a lot of night defences and these can be more dangerous than the day scenarios because of poor visibility in unfamiliar terrain. A number of us have had to deal with situations that we were fortunate to get out of unscathed. The risks could have been reduced by better visibility and availability breathing apparatus. It's not a nice feeling when you're lying on the ground with a hose in your hand in zero visibility and your next breath is going to be smoke! While your average suburban fire fighter has all the necessary equipment at his or her disposal, we as volunteers are limited to what we are supplied and the government in its wisdom has been cutting funding across the board. So it's really up to us in the local community to help those who are helping protect us from this very real threat. **We are currently trying to raise money for helmet mounted torches and better breathing apparatuses for both the Hollisdale and Pappinbarra RFS vehicles.** Any donation over \$2 is tax deductible and would be very much appreciated by the volunteers who may one day be defending your property. Please contact me on 6587 6185 to donate or for further information.

Damian Privett

Fire Permits to burn off **are required** until further notice.

Permits are valid for 7 days only.

Prior to a burn you are required to give your neighbours 24 hours notice in advance.

IN CASE OF FIRE – CALL 000

Fire Permit Officers:- Upper Pappinbarra: Steve Ostler 6587-6090, Bob Ostler 6587-6180, Anthony Wall 6587-6127 or Andrew Jarrett 6587-6181; Hollisdale and Lower Pappinbarra: Lyn Blythe 6587-6186; Beechwood: Sam Elphick 0428-856-222.

Days Gone By—In 1888, the Hon. James Young, member for Hastings and Manning in the Legislative Assembly from 1880-1894 travelled through his electorate and his movements were reported in instalments in the *Port Macquarie News* by our *Travelling Reporter*. After leaving Rollands Plains he travelled through Bellangry to reach our fair valley.

"After crossing Frazer's Creek, we came to the Pappinbarra Creek, both of which are tributaries of the Hastings River. We passed the residences of several settlers on the Pappinbarra, but the amount of agricultural land available appears to be very limited, and confined to a narrow belt along the bank of the creek, which is one of the best in the colony for water. Here,

too, we had testimony of the privations and hardships through which settlers pass in their struggles to make homes for themselves. Near the road stood what I took to be stack of posts, covered by a few sheets of bark; but our guide soon threw more light upon the matter, by informing me that this was the residence of a selector. The "house" consisted of an enclosure about 12ft. square, built of fencing posts, and these supported a flat roof of bark, just sufficiently high to admit of entrance. It was suggested by our honourable friend that the advantage of such a building would be found in its admissibility for firing a gun through what might be termed port holes in the event of such a necessity arising through invasion by enemies.



High Quality
Hay & Silage
Taree
Hay - small squares
Suitable for cattle & horses
J.F. & L.R.
Longworth & Sons
Peter 0438 950 900



www.bellrowanvalley.com.au
BELLROWAN VALLEY
EST. 2001
HORSE RIDING
Daily trail rides
and treks: **Overnight packages**
2 & 3 day trek
Pub Ride - 2 days
Beginners to experienced riders welcome
Bookings essential
6587 5227



WAUCHOPE
Upholstery
Lounge, dining cushion covers
and recliners
Recovered and Repaired
For the best
seat in the
house
6585 6700
Fax: 6585 6798
Free quotes



call an
Angel
House & garden maintenance
By women who care
Call Jan & Mary
6587 6055

Pappinbarra Landholders Conservation Group— Pappinbarra Frog Study Group leaps into being

The PFSG (pronounced poofsoog) has sprung into being with a starting membership of 10 frog enthusiasts – an ideal number to begin the task of surveying frog populations in the Pappinbarra Valley. Our goal for the next year or two is to find out what species live in the valley, where they live, what habitats they use and what conditions they need to breed successfully. So we will be out on rainy evenings, looking, listening and learning – just as soon as it decides to rain again. Anyone who missed out on the introductory talks but might like to get involved can call Ken Aplin on 65876129.

Bandicoots—Bandicute?

Bandicoots can be right pests in the garden and it is impossible not to get irritated when they chose to dig for worms or grubs right in the middle of a freshly planted garden bed or patch of lawn. But every time we see bandicoot diggings or catch a glimpse of the culprit as it bounds away into cover, we can get a thrill to think that these peculiar marsupials are still with us in the Pappinbarra Valley.

In most other parts of Australia bandicoots vanished along with most of the native mammals in the 1920s to 30s, probably due mainly to clearing of bush and the spread of rabbits and foxes. Some species of bandicoots are now extinct while others are found only in reserves. But here in the Valley we have not just one but two

different kinds – long-noses (*Perameles nasuta*) and short-noses (*Isodon macrourus*). Apart from the difference in nasal splendour they also differ in the texture of the fur – long-noses are softer furred while short-noses have stiffer fur due to the presence of thickened hairs called spines. Both kinds are nocturnal and omnivorous. They grub around for worms, beetle larvae and tasty tubers. Luckily they don't dig burrows but instead sleep during the day in a pile of leaves that they scratch together, often at the base of a tree or beside a log. Bandicoots live alone and courtship and mating is brief and probably unromantic ... although ... we have heard local bandicoots making a funny noise not unlike a kiss. This doesn't seem to be reported from other



Long-nosed Bandicoot



Short-nosed Bandicoot

places, so perhaps there is something about Pappinbarra Valley that encourages the romantic in all of its residents! After the romance comes the hard work of child-bearing and rearing. Not so hard for female bandicoots which have among the shortest pregnancies of any mammal – a mere 12 and half days. The tiny newborns weigh around 0.25 grams and make their own way to a pouch that opens backwards so that it doesn't fill up with soils when the mother is digging. Bandicoot milk is incredibly rich and by 7 weeks of age the young are booted out of the nest and off fending for themselves. Although females can start reproducing at only 5 months of age, many do not survive that long but instead become food for goannas, pythons, owls and foxes, and even the mighty Quoll that also still hunts in the Pappinbarra Valley. More about them in a future *Pitchfork*.

Ken and Angela, Tullamore

Hastings Kitchen Co.

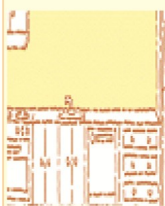

Pty Ltd.

Lic. no. 96036C

202 High St
Wauchope

Kevin
Hughson

Mob: 0407 397 421

☎: 6586 4545

hastingskitchens@tsn.cc



Postage/parcel services
Bill payments
Wine sales

ph/fax: 6585 6109

Mon-Fri: 8:30am - 6pm
Sat & Sun: 9am - 12pm

Bella Bago Choir



invites you to come and sing

**Mondays 6-8pm,
Wauchope Arts Hall,
Bain Park, Wauchope**

No experience necessary - just a
passion for singing and a
willingness to learn.

Elly Franchimont: 6587 6097 or
0424 220 937
elly@vocalpointevents.com

Alex Irving Solicitor

Conveyancing,
wills, estates,
injury claims

Cowal Creek Rd, Bellangry 2446

Tel: 6587 5112

Fax: 6587 5113

irvingsolicitor@harboursat.com.au

Port Maquarie Hastings Council - Natural Resource Management Update

Roadside Weed Control

Get ready to see control of invasive weeds along rural roads in your area. PMHC has secured \$48,000 to control invasive weeds in the Upper Camden Haven and Comboyne Plateau. To complement this effort, Council will be employing another invasive weed officer to provide a full time roadside weed control effort **for all rural roads in the LGA**. Where required, Council's Invasive Species Coordinator Grant Taylor will be contacting landholders to gain agreement and access to treat fence lines adjacent to road reserves. Over time the entire 20m wide road reserve will be treated and maintained for all invasive weeds, which will be a major benefit in the battle against weed invasion into farmland, rivers and bushlands.

Significant Roadside Vegetation and Habitat Trees

To complement vegetation mapping and roadside weed control,

Council has completed an audit of all significant habitat trees, koala food trees, remnant patches of Endangered Ecological Communities and rare and threatened plants within the rural road reserves in the LGA. This data will help Council avoid or mitigate impacts on this important vegetation whilst undertaking roadside maintenance works.

Ecohealth - a check of the health of our waterways

In partnership with the Northern Rivers Catchment Management Authority, University of New England and University of New South Wales, Council will be completing a 12-month comprehensive health check of our waterways including the major freshwater and estuarine water bodies in the LGA. Report cards for each catchment will be available at the end of the year.

Thor Aaso, Natural Resources Officer 6581-8692

GPG Control by Slashing

In the September Issue of *Pitchfork* Peter Michael wrote about crown rot fungus for Giant Parramatta Grass control. Slashing three times over summer/early autumn is another way of controlling this weed. From Grant Taylor - "The purpose of the slashing is to reduce/prevent seeding of the GPG so it needs to begin about mid to late December, depending on the seasonal conditions. The second growth of seed heads will be lower in height and have less seed, and will probably need to be slashed in late January or early February. The third growth will generally be lower again and will be best slashed in March/April. A lot of landholders don't like to slash this late in the season because they won't get any new pasture growth before winter. The reality is that the GPG has very poor feed value this late in the

season, and slashing provides the opportunity to oversow rye and/or clover for winter feed. This improves the productivity of the paddock, and also removes any advantage the GPG has by bringing all the pasture back to an equal footing so all the grass species start from the same point next season. The regrowth after slashing can be managed to an extent by grazing, where possible, as the short summer growth is quite palatable to stock. The work David Officer has done with the *Nigrospora* fungus seems to indicate that slashing helps to promote its spread throughout the paddock. This is contradicting what was considered previous best practice but it seems to work!"

Grant Taylor, Noxious Weeds Coordinator 65818224 or 0429818011

In the Veggie Patch this Month

This is the optimum time to plant all the vine/runner vegies - rockmelon, watermelon, honeydew and pumpkins. Why not try growing Rosella or Pepino? They love hot summers. Keep your veggie patch cool and moist by applying mulches, such as sugarcane or pea straw. Adding water crystals to the planting hole will aid the establishment of your crop.

Alison Robinson, Greenbourne Nursery

Rosella (*Hibiscus sabdariffa*) - an attractive annual shrub to 1.5 m high with large, lobed reddish leaves and attractive yellow hibiscus-like flowers; the fleshy calyx is used in salads, jellies, cranberry-like sauces, jam and cordial, syrups and wine; dried red calyx is used for tea and is an important ingredient in the

commercial *Red Zinger*, *Hibiscus* and *Fruit* teas; the tea is very similar in flavour to rose-hips and high in vitamin C. <http://greenharvest.com.au/SeedOrganic/VegetableGrowingInformation/RosellaGrowingInformation.html>



Pepino (*Solanum muricatum*) - a small, herbaceous shrub that produces small fruit that tastes similar to cantaloupe; similar to growing tomatoes and can be grown in pots; purple and white fruit take 9-12 months to grow; ideal for anywhere that doesn't receive frost.

<http://www.abc.net.au/gardening/stories/s2233909.htm>

ecoWild!
health food · organics · products from nature
organic fruit & veg
bulk flour, grain, rice, nuts
dairy, cosmetics, vitamins
groceries, bedding
dedicated to healthy living
Mon-Fri: 9am - 5pm
Sat: 9am - 12:30pm
Sun: by appointment
Bransdon St
Wauchope
65852424

Hastings Co-op
Mitre 10 & CRT
◆ Hardware ◆ Farm supplies
◆ Animal feed ◆ Pool supplies
◆ Pump & irrigation
& lots more!
Pappinbarra deliveries every Friday right to your door!
Ph: 6585 1655 1 Carrington St
Open Mon-Fri 8am - 5pm. Wauchope
Sat 8am - 12pm, Sun 9am - 1pm.

travelWorld
Wauchope
Canada and Alaska
group tour escorted by
James and Robyn Flanagan
Expressions of interest:
6585 2288
21 days
May 2013

Beechwood General Store & Café

Your convenience store & café
Trading hours:
8am - 6pm 7 days
groceries, local produce and more!
CAFÉ OPEN DAILY
Breakfast, Lunch & Snacks
Dine in (BYO) or Take-Away
Group bookings and A/H functions
Phone Wendy on 6585 6130

NOVEMBER 2012

| Mon | Tue | Wed | Thu | Fri | Sat | Sun |
|-----|--------------------|---------------------------|------------------|--------------------|--|--------------------------|
| | | | 1 Tennis 7–10pm | 2 First Friday 6pm | 3 Yoga 8am | 4 |
| 5 | 6 Exercise 1:30pm | 7 Bellangry Pottery 10am | 8 Tennis 7–10pm | 9 | 10 Yoga 8am, Saturday Sing Along 10am-12pm | 11 |
| 12 | 13 Exercise 1:30pm | 14 Bellangry Pottery 10am | 15 Tennis 7–10pm | 16 | 17 Yoga 8am | 18 |
| 19 | 20 Exercise 1:30pm | 21 Bellangry Pottery 10am | 22 Tennis 7–10pm | 23 | 24 Yoga 8am, Farmers' Market 8am–12pm, Concert Bec & Dave Mann 6pm | 25 All Saints Church 2pm |
| 26 | 27 Exercise 1:30pm | 28 Bellangry Pottery 10am | 29 Tennis 7–10pm | 30 | | |

Look through the *Pitchfork* for details of the events and programs found in the calendar.

Hastings Farmer's Market

There's good coffee to be had with cake and chocolates and local shopping to be done at the Hastings Farmers Market this month. Now is the time to purchase locally made gifts for Christmas. Come and enjoy the friendly atmosphere at the market, meet up with friends you haven't seen for a while and listen to the Hastings Community Choir sing their hearts out for you. The market will take place rain, hail or shine at the **Wauchope Showground** from **8 am to 12 noon on Saturday, 24 November**.

Darren Rowley Electrics



- *New Homes
- *Rewiring
- *Mini-excavation
- *Cable Locating
- *Underground Cabling

For all your electrical needs
Ph: 6587 6076 or
0418 435 189

**Export Quality
Paspalum
Seed**

Direct from grower/processor

**25 kg bags -
\$8/kg + GST**

Dave: 0417 073 187
J.F. & L.R. Longworth
& Sons, Coopernook

Hastings Farmers' Market
the **4th Saturday**
of each month



Wauchope Showground
8am - 12 noon rain, hail or shine

Enquiries: phone 6587 6097, 0424 220 937
or email elly@vocalpointevents.com



**Buy fresh
Buy best
Buy local**



Large range of
**trees, shrubs
& fruit trees**

Wide range of
seedlings

Pots & giftware

NURSERY see us on
WAUCHOPE thebusinesstree.com.au

239 High St. Wauchope
(opposite Timbertown)
Open 7 Days 65852117

Hayden & Alison Robinson
greenbournenursery@midcoast.com.au

POA Folds

At the meeting of the Pappinbarra Outback Association last Sunday it was agreed that it had not been possible to enlist any further support for forming a committee to run the Association. As a result the only course of action was to pass a resolution to cancel the Association's registration with Fair Trading. So, sadly, this means the end of the Outback Association.

Many people have worked hard over the years to establish the tennis court and meeting room at the recreation grounds. The facility, owned by Port Macquarie Hastings Council, will remain open thanks to the formation of a separate S355 committee – members are Sue Frost, Kelly Benson, Steve Ostler, Emma Frost, Brenda Patrick and Rob Frost. This committee will be responsible for keeping the area open for hire, taking bookings and collecting

fees for Council. It will not be organising any functions but will continue to do ground maintenance. Council will continue to maintain the building.

The Pappinbarra Progress Association has stepped in to fill the gap and it is hoped that all the traditional POA activities will continue, including the tennis tournament.

Anyone wishing to hire the tennis court or meeting room can book by ringing Sue Frost on 6587 6129. Hire fee, set by Council, is \$5 per hour. Casual use of the grounds (excluding the tennis court) is free. Camping is not allowed.

Sue Frost

Visit to Hollisdale Hall by Our New Mayor

Members of the PPA committee were pleased to host a familiarisation visit by Peter Besseling, accompanied by General Manager Tony Hayward, to the Hollisdale Hall on 3 October as part of a tour of outlying communities. "It is vital early on that the new Council make an effort to understand local issues, support local community groups and be most effective as democratically elected representatives," Mayor Besseling said. "It is also crucial that our community groups have the opportunity to discuss these issues directly with our General Manager and that these concerns are relayed through to both our Councillors and our senior council staff." The committee talked about local issues and PPA's plans and hopes for the coming years.



Lyn Blythe, Jean Hegarty, Peter Besseling, Jan Childs, Tony Hayward and George Hegarty

Kid Spot

We'd love to feature stories, poems, favourite recipes and jokes by and for the kids in the Valley. So kids (and grownups), send your stuff to bsibthorpe@bigpond.com. Here are some things to get the ball rolling: "Knock knock" "Who's there?" "Boo" "Boo who?" "Don't cry, it's only a joke!"

Fabulous Fettuccini—a favourite of young chef Chloe Bennett (aged 9)

- 1 pkt fettuccine
- 4 rashers bacon
- a handful of mushrooms, chopped
- 1/2 cup cream
- 3 spring onions, chopped
- 1/3 cup grated cheese

Cook fettuccini in boiling, salted water. Drain well.
Chop and fry bacon. Stir in mushrooms and cook until soft.
Add spring onions and cook lightly.
Add cream and simmer for 5 mins.
Combine with cooked fettuccini, mix well.
Serve in bowls sprinkled with grated cheese.
This goes well with home-made garlic bread and a green salad.
YUM! (serves 4)



1. How do monkeys grill their toast in the jungle?

Under the gorilla.

2. What is the time when an elephant sits on your fence?

Time to get a new fence.

3. How do you make a tissue dance?

Put a little boogie in it! Eeuughhhh!

 **Jamax Forest Solutions**
"We can see the forest through the trees!"

- ▲ native forest and plantation management
- ▲ harvest planning and supervision
- ▲ domestic and export sales and marketing
- ▲ private native forestry property vegetation planning
- ▲ bushfire prevention and mitigation

Steve 0427 990 317
www.jamaxforestsolutions.com

 **Mark Art**
Painter & Decorator

Mark John Purdy
Quality Painting
30 years experience
Colour your home or business

179 Lemon Gum Rd Lic. no. 131908C
Pappinbarra 0421 046 851
NSW 2446 AH: 6585 6777

Regular Events

First Friday

When: First Friday of the month, 6pm onwards

Where: Hollisdale Hall

What: BYO drinks and nibbles, low cost BBQ including vegetarian option, member's draw (cash prize) and raffle

Contact: Jean Hegarty 6587-6077

Yoga

When: Every Saturday morning, 8-9.30AM

Where: Hollisdale Hall

What: \$15 (mats are provided)

Contact: Amy Hubers stillpointyogamassage@gmail.com 6585-3470

Saturday Sing Along

When: Second Saturday of every month, 10am -12md

Where: Hollisdale Hall

What: \$10 (\$5 of which goes to the PPA); morning tea (bring something delicious to share if the urge takes you)

Contact: Elly Franchimont 6587-6097 or 0424 220 937

www.vocalpointevents.com

Exercise

When: Tuesday afternoons 1:30—2:30pm

Where: Hollisdale Hall

What: Equipment provided

Contact: Lyn Blythe 6587-6185 or Beverly Kilpatrick 6587-6112

For Sale

Tullamore free range eggs from happy chooks – \$3 per doz. delivered to your letterbox on Pappinbarra Road and Beechwood. To order email Angela Frost angfrost@hotmail.com or phone 6587-6129.

Pitchfork

Circulation

Pitchfork has hardcopy and email circulation of approximately 280. It comes out on the Friday **before** First Friday – **Friday, 30 November** for the **December** Issue. Material for the December Issue to the Editor by **Wednesday, 21 November**. We run both casual and regular **advertisements** at very competitive rates. Contact Chay Khamsonne.

Production Team

PPA Executive: Jan Childs janmary1301@bigpond.com 6587-6055

Editor: Bev Sibthorpe bsibthorpe@bigpond.com 6584-0051 or 6587-6075

Production: Angela Frost angfrost@hotmail.com

Advertising: Chay Khamsonne kwanchay@hotmail.com 6587-6022

The views expressed in *Pitchfork* are not necessarily those of the PPA or POA.

Pappinbarra Progress Association Committee

Executive:

President: Jean Hegarty 6587-6077

Vice President: Mary Walker 6587-6055

Treasurer: Jan Childs 6587-6055

Secretary: Elly Franchimont 6587-6097

Other Members:

Kelly Benson Chay Khamsonne

Lyn Blythe Bev Sibthorpe

Sue Frost

PPA Matters

PPA Committee meetings – monthly at 5:00pm before First Friday – all welcome.

Facilities for Hire

Hollisdale Hall – contact Jan Childs 6587-6055. Upper Pappinbarra facilities and tennis court - contact Sue Frost 6587-6129

All Saints Church

Services are held

every fourth Sunday

at 2 pm with a cuppa

'off the back of the ute' around

2.45p.m. All welcome.

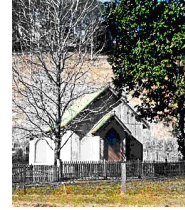

PPA Membership now at 77

Can we reach 100? Membership is very important to us – not only does the small fee help with the many costs of keeping the Hall and Association alive, but good membership numbers help make us competitive for grants, the lifeblood of Hall maintenance and improvements. You can join the PPA at any time of year.

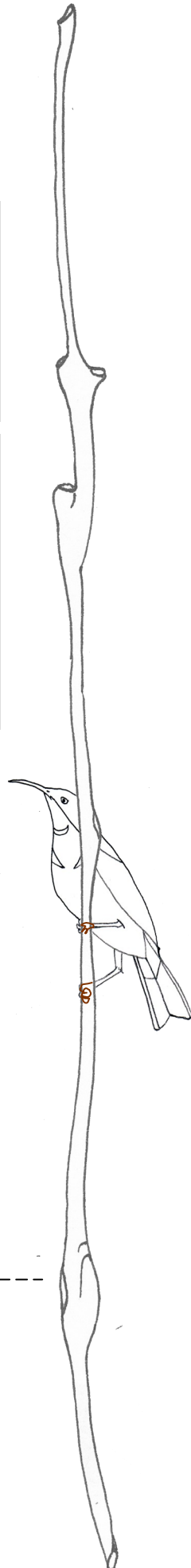

PPA Membership 2012-2013

\$5 per adult

PLEASE PRINT

Member Names: _____

Address: _____

Email: _____ Phone: _____

Payment amount: _____

Send cash or cheque made out to "Pappinbarra Progress Association" to: Jan Childs, 1301 Pappinbarra Rd, Pappinbarra NSW 2446.